

# operating instructions



## Foster European Operations

**France**  
Foster Refrigerator France SA  
Tel: (33) 01 34 30 22 22 Fax: (33) 01 30 37 68 74 Email: info@fosterfrance.com

**Germany**  
Foster Refrigerator Germany  
Tel. (0781) 9907840 oder 0700-00FOSTER, Fax (0781) 9907844, E-Mail info@foster-de.com  
www.fosterrefrigerator.de

## FHC 500 XM/S Heated Cabinet installation and operating instructions

- GB Operating instructions
- D Bedienungsanleitung
- F Notice d'installation et d'utilisation



**Foster Refrigerator Group of Companies,**  
Oldmedow Road, King's Lynn,  
Norfolk, PE30 4JU  
England

Tel: 01553 691122  
Fax: 01553 691447  
Website: www.fosterrefrigerator.co.uk  
Email: sales@foster-uk.com

FHC 500XM/S/OP/EN/0810 00-556236



## installation

### IMPORTANT:

To the installer: Installation of these units should be carried out by a competent person and the appropriate codes of practice adhered to, thus ensuring safe installation. **Pass to the user: Do not discard this document. It contains important guidelines on Operation, Loading, Cleaning and Maintenance and should be kept for reference.**

### DISPOSAL REQUIREMENTS

If not disposed of properly all refrigerators have components that can be harmful to the environment. All old refrigerators must be disposed of by appropriately registered and licensed waste contractors, and in accordance with National laws and regulations.

### 1. Positioning/unpacking

#### Unpacking

The cabinet is mounted on a pallet and shrink-wrapped. Keys and wiring diagram are supplied in a box inside of the cabinet. Carefully remove the shrink-wrapping. Make sure that any sharp instrument used does not damage the cabinet. Remove protective plastic film from cabinet body. For clean removal, carefully run a sharp blade along joints and edges.

#### Removal of pallet

Remove fittings from inside the cabinet. Unbolt the retaining bolts which secure the cabinet to its pallet. Move the cabinet over the back of the pallet and bolt castors into the rear castor mounting holes. To fit the front castors, tilt the cabinet backwards, remove the pallet and bolt the front castors into the front mounting holes.

### 3. Shelving

#### Removable Shelf Support Uprights:

The cabinet is fitted with removable ladder rack to facilitate ease of cleaning. It can be removed by unfastening the thumb screws located along the upright.

### 4. Shelf/Tray Supports

To fit the trayslides insert the bottom projection into the vertical support and twist the trayslide with an upward motion to engage the top projection. Ensure the trayslides are parallel and level after fitting.

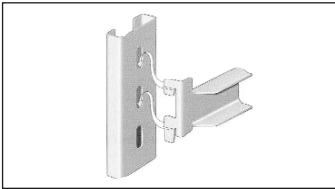

### 5. Internal Humidity Tray

To help prevent uncovered food from drying out fill the humidity tray to approximately 2/3 full. During operation the water will evaporate and re-filling the tank will be required.

## Cabinet Operation

### 6. Cabinet Operation

The cabinet is turned on and off via the use of the green switch on the front of the cabinet. If the cabinet is not to be used for a long period of time we would recommend it be disconnected from the mains supply.

#### Controller Operation



LTR-5CSRE-A Controller (00-556186)

- ⬇️ Setpoint Button    ⬆️ Increase Button
- ⬇️ Decrease Button    ⏻ Exit/Stand-by Button

### 7. Display

During normal operation, the display shows either the temperature measured or one of the following indications:

- off Controller in stand-by
- or Probe T1 Out of Range or failure

**Setpoint** (Display and modification of desired temperature value)

Press button for at least half a second, to display the setpoint value.

By keeping button pressed, use button or

to set the desired value (adjustment is within the minimum SPL and the maximum SPH limit).

When button is released, the new value is stored.

### Warning- Electricity at Work Regulations 1989 (UK)

Before commencing any testing on this appliance for conformity with the requirements Electricity at Work Regulations refer to supply dealer guidance on testing.

Some equipment is furnished with low voltage electronic components which may be irreparably damaged if incorrect testing is applied. Foster Refrigerator (UK) Ltd accepts no responsibility for failures resulting from inappropriate testing.

### 10. Switching On

Allow cabinet to reach storage temperature before loading.

#### Before Loading

Wipe the cabinet interior with a cleaner approved for food contact surfaces before loading food.

Cabinet supplied with suitable plug ready for direct connection to the mains supply.

Switch on via the green illuminated on/off switch. The cabinet is supplied with internal humidity tray, this should be filled with water prior to loading the food to help prevent uncovered food drying out.

NB. Designed to hold pre-heated food not to heat food.

## cleaning/maintenance

**NB. Before internal cleaning, switch off cabinet using the on/off switch on the control panel facia.**

### 11. Cleaning Instructions

#### IMPORTANT:

Cared for correctly, stainless steel has the ability to resist corrosion and pitting for many years.

We recommend daily cleaning with:

- a. a spray cleaner or bactericide approved for stainless steel surfaces.
- b. hot soapy water followed by wiping down with lint free towelling.

Always clean with the grain of the metal.

NB. Do not use ammonia-based cleaners on aluminium.

#### WARNING:

High alkaline cleaning agents or those containing bleaches, acids and chlorines are very harmful to stainless steel. Corrosion and pitting may result from their accidental or deliberate application.

If any of these liquids should come in contact with your refrigerator during general kitchen cleaning, wipe down the affected area immediately with mild soapy water and rub dry.

Never use wire wool or scouring powders on stainless steel or aluminium surfaces. Stubborn staining of steel surfaces can be removed with a non-abrasive cream cleaner or, in extreme cases, gentle rubbing with 'Scotchbrite' in the direction of the grain.

### Internal Surfaces:

Remove all contents and fittings at least once a month for thorough cleaning of shelves, floor and walls, using a mild disinfectant. Dry all surfaces and allow cabinet to reach storage temperature before reloading. Check guards are secure.

NB. All foodstuffs must be stored in back up store before the cleaning period. Any spillages must be wiped clean immediately.

### Door Gaskets:

Clean monthly. Replace if not sealing correctly.

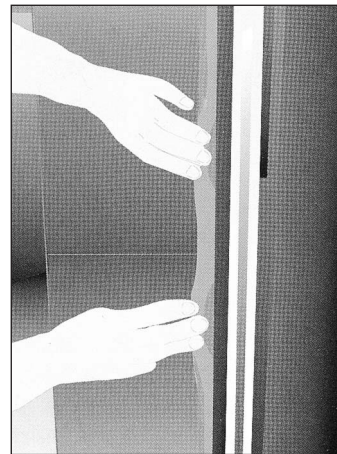

### Castors

Check monthly to ensure secure fixing.

## hazards

### 12. Hazards

Safeguard children when discarding an old cabinet by breaking off door latches, locks and hinges.

## operational failure

### 13. Problem Diagnosis

Checks must be carried out by a competent person.

Before calling a Foster Authorised Service Company check the following:

- a) Power failure (may be off at source)
- b) Plug may be loose or pins bent preventing contact.
- c) Blown fuses.
- d) Low voltage in line.

When requesting service assistance always quote the following:

- a) cabinet serial number (E.....)
- b) cabinet model number

Both taken from the silver label located inside cabinet door.

The cabinet is fitted with an Overtemperature safety device, if the red light illuminates, please contact your service provider.

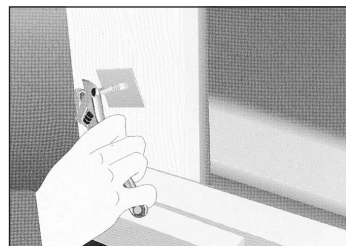

### 2. Castors

These are boxed with the shelves and shelf supports inside the cabinet. FHC500X models are supplied with 100mm castors, fixed to the front and lockable swivel to the rear.

NB: Ensure that the castors are securely tightened on installation.

Check the level of the cabinet with a spirit level. Cabinet levels may be adjusted by inserting spacer washers between the appropriate castor and the base of the cabinet.

